

GL

GINGIVAL
LEVEL
implant

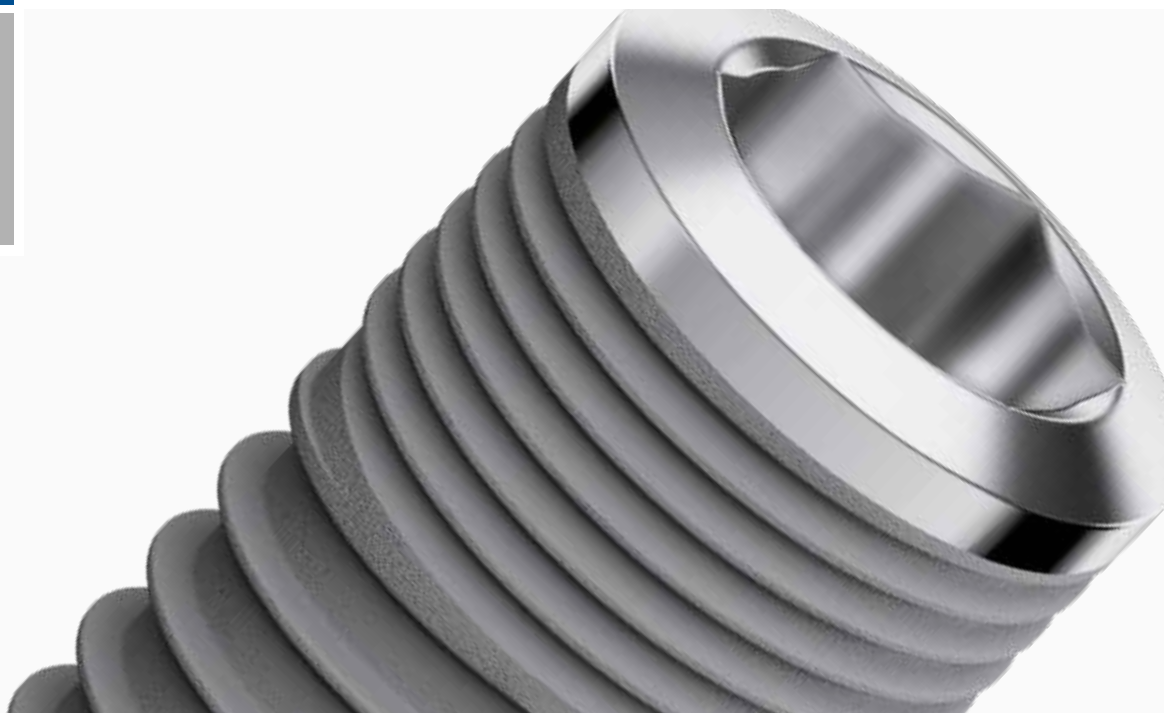

C-TECH
IMPLANT

GINGIVAL LEVEL implant

Implant characteristics	page 04	Laboratory accessories	page 15
Dental implant	page 06	Surgical instrumentation	page 16
Titanium healing abutment	page 07	Surgical kit	page 17
Prosthetic components	page 07	Reduced surgical kit	page 18
Cemented prosthesis procedure	page 10	Instrumentation	page 19
O'ball attachment system	page 11	Site preparation	page 24
Bar	page 12	Implant packaging	page 26
Anchor abutment system	page 14	Implant labeling	page 26



All of the materials produced by C-TECH follow a validated procedure, which includes surface treatment and packing as well, in conformity with European and international directives EN ISO 13485:2003/AC:207 and 93/42/EEC relative to medical devices.

Precision dental solutions

C-Tech Implant is a dynamic company with aggressive growth, producing components and product lines primarily for dental implantology.

International presence

With production and management based in Italy, C-Tech Implant is active in all major world markets and is distributed in over 25 countries.

Scientific research, advanced technology and simplification

C-Tech Implant differentiates itself with attention to research and the application of high technology to its products, all while maintaining a simplicity of insertion and ease of use.

C-Tech Implant incorporates the latest trends in implantology but provides very practical surgical and prosthetic solutions aimed at offering the practitioner and the patient optimal results.

High quality standards

C-Tech Implant products are made to the highest standards governing the manufacturing and management of European medical and dental components.

Up to date audits and certifications assure that these standards are vigilantly maintained.

Training & advice

Dental professionals are assisted by the rich knowledge and experience of C-Tech Implant personnel and through C-Tech courses and training sessions.

During these courses the professional is able to learn the latest methods of implant placement and reconstruction.

Mission statement

The goal of C-Tech Implant is to provide the highest level of quality for technologically advanced products at reasonable prices in order to allow the dental practitioner to find solutions for the broadest range of patients.



GINGIVAL LEVEL implant

Convex platform

The convex implant platform, in conjunction with the concavity of the implant's base form a "suction cup" fit, once the abutment is tightened into final seating.

Polished gingival collar

Extending down for one millimeter down from the top of the implant platform, the polished surface is ideal for accommodating the gingival tissue.

Micro-threading

The micro threads increase functional surfaces, adapting them to the compact cortical bone tissue and safeguard it against aggression from larger threads to be found in conventional implants. The micro-threads are essential to the maintenance of cortical bone height around the implant.

Single internal hex connection

The complete GL family is endowed with a single connection. Independent of the implant diameter, one abutment fits all. Thus reducing system complexity and cost.

Double helix threading

The double-helix design sets C-TECH Implants apart from the single helix implants by giving them a more symmetrical introduction into the bone. This translates into masticatory load balance which drastically reduces stress. Its symmetry also renders the implant self-centering, eliminating any form of misalignment in terms of the main axis of the osteotomy site. The pitch of the threads allows for an insertion time that is reduced by half.

Passivated surface

The implant surface is blasted with aluminum oxide and then subjected to progressive etching using citric acid. This surface treatment accelerates the osseointegration process by providing a greater and more uniform area of contact between bone and implant while favoring an immediate implant load. The treatment provides for a uniform surface with progressive trabeculation to be achieved.

An additional advantage of the citric acid treatment is that it leaves no traces following decontamination, further reducing the risk of implant failure.



Dental Implant

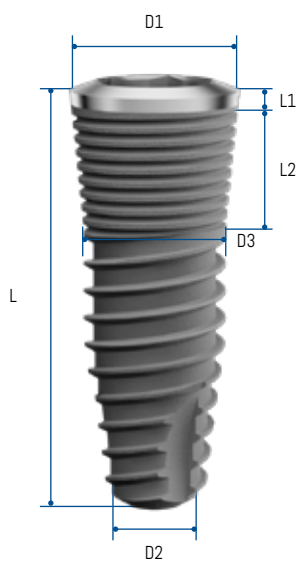

GL implant $\varnothing 3.5$

D1	D2	D3	L	L1	L2	item#
4.3	2.6	3.5	8	0.5	3.3	CT-3508
			9			CT-3509
			11			CT-3511
			13			CT-3513
			15			CT-3515



CT-3508
8 mm

CT-3509
9 mm

CT-3511
11 mm

CT-3513
13 mm

CT-3515
15 mm

GL implant $\varnothing 4.3$

D1	D2	D3	L	L1	L2	item#
4.3	3.2	4.3	8	0.5	2.3	CT-4308
			9			CT-4309
			11			CT-4311
			13			CT-4313
			15			CT-4315



CT-4308
8 mm

CT-4309
9 mm

CT-4311
11 mm

CT-4313
13 mm

CT-4315
15 mm

GL implant $\varnothing 5.1$

D1	D2	D3	L	L1	L2	item#
5.1	4.0	5.1	8	0.5	2.3	CT-5108
			9			CT-5109
			11			CT-5111
			13			CT-5113
			15			CT-5115



CT-5108
8 mm

CT-5109
9 mm

CT-5111
11 mm

CT-5113
13 mm

CT-5115
15 mm

Titanium healing abutments

Cover Screw

D	L	C
4.3	1	2.2

Material: Titanium grade 5

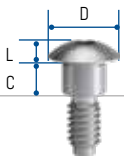

CT-4305

Titanium healing abutments

D	L	Fixture	C	item#
5.6		1.5	2.2	CT-43150
		3		CT-4330
		4.5		CT-4345
		6.5		CT-4365
		8.5		CT-4385

Material: Titanium grade 5



Prosthetic components

Closed tray impression post Includes screw and plastic cap

L	D1	D2
13	545	264

Material: Titanium grade 5

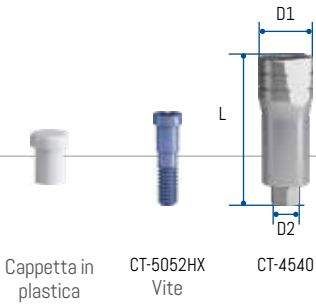

Impression post screw

L	D1	D2
26	3.3	1.9

Material: Titanium grade 5



CT-5050L

Open tray impression post Includes impression post screw

Material: Titanium grade 5



CT-4542

Implant lab analog

L	D	codice#
12	4.3	CT-5143
	4.6	CT-5151

Material: Titanium grade 5

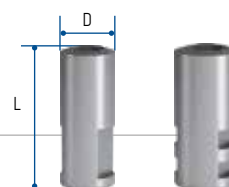

CT-5143
3.5mm/4.3mm

CT-5151
5.1mm

O-Ball lab analog

L	D
16.3	4.3

Material: Titanium grade 5



CT-5144

Shouldered abutment analog

L	D
17.78	4.3

Material: Titanium grade 5

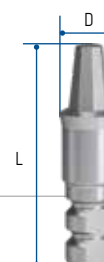

CT-5145

Titanium straight abutment Includes screw

L	D	C
9	4.3	1

Material: Titanium grade 5

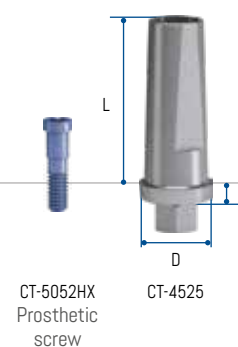

CT-5052HX
Prosthetic
screw

CT-4525

Titanium base Includes screw and castable cylinder

L	L1	D
10	5	4.3

Material: Titanium grade 5 and Plexiglass

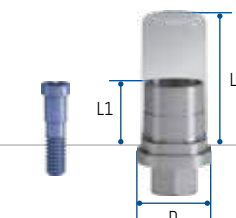

CT-5052HX
Prosthetic
screw

CT-6045

Castable abutments Includes screw

L	D1	D2	item#
12	4.55	2.62	CT-5845
9.8	4.58	2.64	CT-5645

Material: Plexiglass

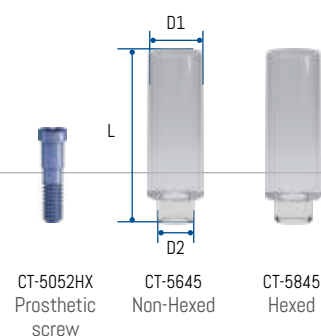

CT-5052HX
Prosthetic
screw

CT-5645
Non-Hexed

CT-5845
Hexed

Titanium angled abutments Includes screw

L	D	C	G	item#
7.3	4.3	1	15°	CT-1543
		1	25°	CT-2543

Material: Titanium grade 5

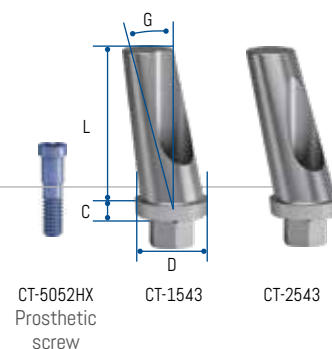

CT-5052HX
Prosthetic
screw

CT-1543

CT-2543

SSA drive

L	D1	D2
19.3	7.9	5.64

Material: Titanium grade 5



E9040

Non-hexed shouldered abutment Includes Castable Cap

L	D1	item#
6.3	4.72	CT-5545
5.08	4.75	CT-4645

Material: Titanium grade 5

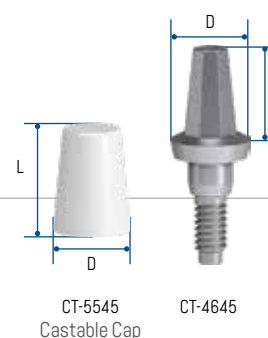

CT-5545
Castable Cap

CT-4645

Cemented prosthesis procedure

STEP 1

Prepare the abutment with burr

STEP 2

Polish the prepared abutment

STEP 3

Place the restoration



PEEK abutments Includes screw

D	L	C	item#
4.3	9	1	CT-4525PEEK
	7.3		CT-1543PEEK

Material: PEEK



Prosthetic screws

L	D
8.8	2.5

Material: Titanium grade 5

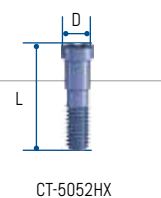

O-Ball attachment system

Intended use

Dentures retained by implants in the mandible and maxilla.



Characteristics

- The clinical process for the ball attachment is quick and easy;
- Functional;
- The O-ring attachment is designed to virtually eliminate wear on the Ball Abutment and minimize the need for maintenance;
- 3 different gingival heights;
- 3 different O-ring resistances offering optimal retention for every individual situation

Reliable

Dual retention for optimal abutment-denture connection. Excellent long-term performance due to high wear resistances of components.

O-ball abutment seating tool

L	D1	D2
19.3	7.9	4.8

Material: Titanium grade 5



O-ball abutments

L	D	D1	item#
0.5	4.7	1.8	CT-5641
2			CT-5642
4			CT-5644

Complete set includes:

1. O-Ring (Ref. MC-3005) 1 piece
2. Metal Housing (Ref. MCH-2)
3. O-Ball Abutment (Ref. CT-5641, CT-5642, CT-5644)

Material: Titanium grade 5

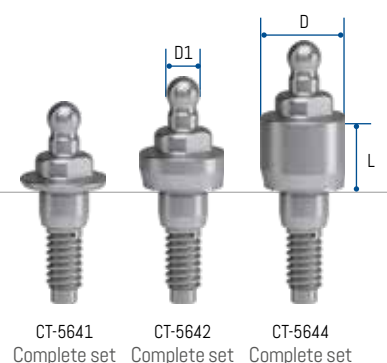

Caps soft retention

L	D
3.5	4.7

Material: Titanium grade 5

o-ring	D
	44

Material: FDA Buna

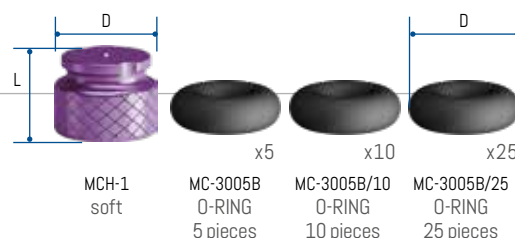

Caps medium & hard retention

L	D	item#
3.2	4.2	MCH-2
2.9	4	MCH-3

Material: Titanium grade 5

o-ring	D
	3.8

Material: FDA Buna



Bar

Titanium base with casting cilinder Includes screw

Material: Titanium grade 5 and Plexiglass

CT-5052HX
Prosthetic
screw

CT-5841

OT-Bar

L	D
23	2

Material: Polystyrene Shockproof ABS

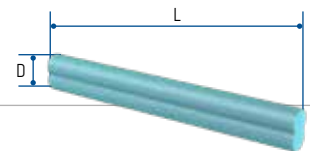

0220BB

Clip Set includes 4 pcs

L	D
5	3

Material: Rylsan

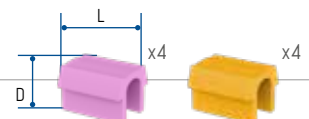
027CRR
Soft027CRG
Medium

STEP 1

Place the castable Multi-unit abutments on the analogs and tighten the Multi-unit internal screws.

STEP 2

Make height adaptations according to the individual situation.

STEP 3

Use a residue-free burn-out plastic to fix the bar segments to the castable abutments.

STEP 4

The clips are fixed into the prosthesis.

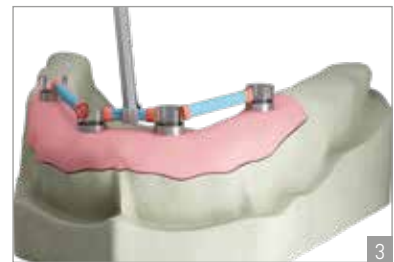

Anchor abutment system

Metal housing 2 pieces

L	D
4.5	1.98

Material: Titanium grade 5

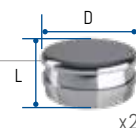

141CAE

Caps 4 pieces

L	D
3.85	1.73

Material: 140CEV - kepitall
140CET/140CER/140CEG - pebax



140CEV strong retention 2.7kg
140CET standard retention 1.8kg
140CER soft retention 1.2kg
140CEG extra-soft retention 0.6kg

Anchor abutment

L	D1	D2	item#
24	4.3	2.5	134CTH1
34			134CTH2
44			134CTH3
54			134CTH4
64			134CTH5

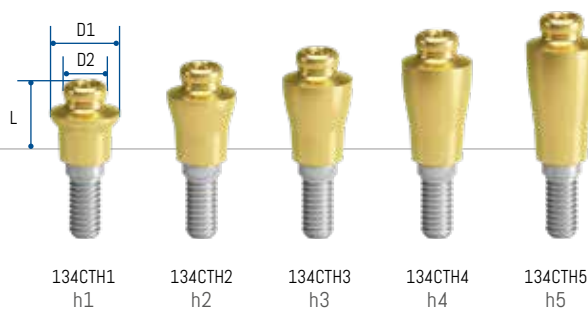

134CTH1 h1
134CTH2 h2
134CTH3 h3
134CTH4 h4
134CTH5 h5

Complete set includes:

- 1 Anchor abutment (Ref. 134CTH1, 134CTH2, 134CTH3, 134CTH4, 134CTH5)
- 1 Stainless steel housings (Ref.141CAE)
- 1 Retentive caps - violet "strong" (Ref. 140CEV)
- 1 Retentive caps - white "standard" (Ref. 140CET)
- 1 Retentive caps - pink "soft" (Ref. 140CER)
- 1 Retentive caps - yellow "extra-soft" (Ref. 140CEG)
- 1 Processing cap - black (Ref.140CEN)

Material: Titanium grade 5

Laboratory accessories

Processing caps - black 4 pieces

L	D
4.5	1.98

Material: Rilsan

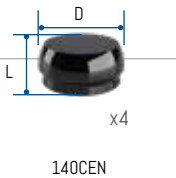

Impression coping 2 pieces

L	D
9	3.7

Material: Acetal

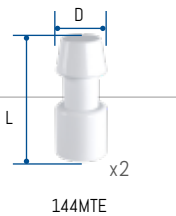

Laboratory analog 2 pieces

L	D1	D2
15.6	4.3	2.5

Material: Stainless steel AISI 303



Pull-off impression coping

L	D
5.5	4.6

Material: Stainless steel AISI 303

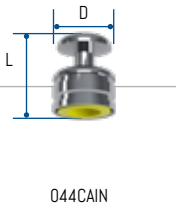

Castable cap

L	D
3	4.3

Material: Crystal polystyrene

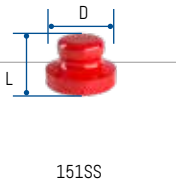

Surgical instruments

Blue plastic "multiuse" insertion tool

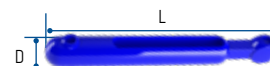

124ICP

L	D
83	11

Material: Nylon

Metal insertion tool for caps



185IAC

L	D
40	4

Material: Stainless steel

Metal extractor tool for caps



191ECS

L	D
40	4

Material: Stainless steel

OT-Equator square screw driver for implant abutment

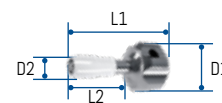

774CHE
square
1.25 mm

L1	L2	D1	D2
17	10.5	9	3.5

Material: Stainless steel

Square driver connector for torque



760CE

L	D
22	2.3

Material: Stainless steel

Surgical Kit

SUR.KIT.01

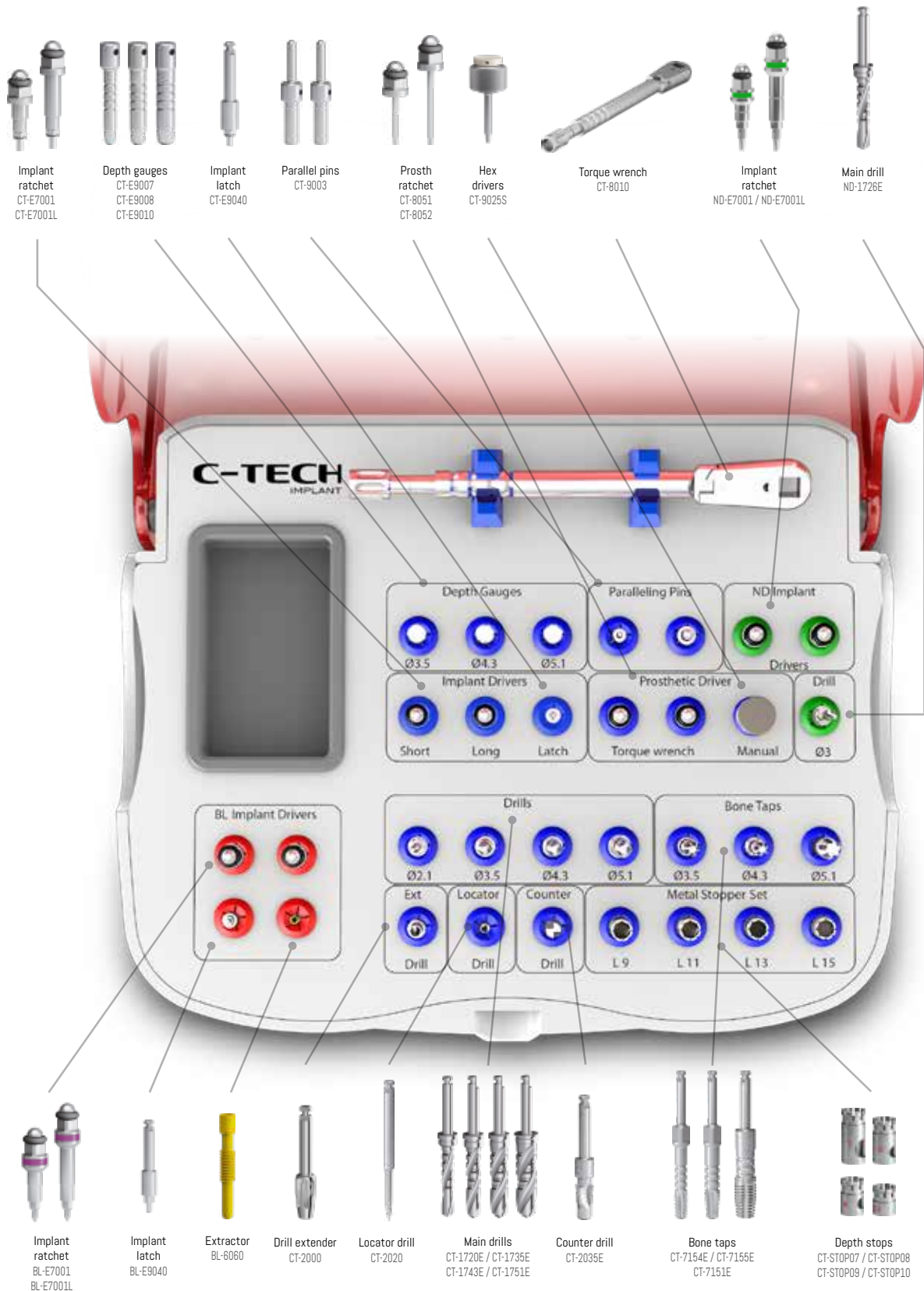

REDUCED Surgical Kit

SUR.KIT.02



Instrumentation

Combined depth paralleling pins

L1	L2	L3	D1	D2
23.5	16.5	5.5	1.9	2.5

Material: Stainless steel

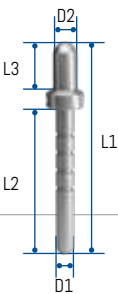

CT-PIN1
1.9 mm
2.5mm

Paralleling pin

L1	L2	L3	D1	D2
24.25	10.25	10	3.05	1.85

Material: Stainless steel

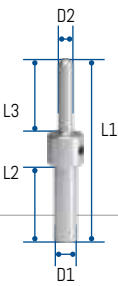

CT-9003
1.6 mm
2.0mm

Depth gauges

L	D	M1	M2	M3	M4	item#
18.5	3	7	9	11	13	CT-E9007
	3.8					CT-E9008
	4.6					CT-E9010

Material: Stainless steel

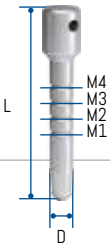

CT-E9007
ø 3



CT-E9008
ø 3.8



CT-E9010
ø 4.6

Implant ratchet driver With retention

L	item#
10.7	CT-E7001
18.7	CT-E7001L

Material: Stainless steel

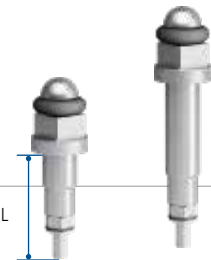

CT-E7001

CT-E7001L

Instrumentation

Implant latch driver With retention

L
27.8

Material: Stainless steel



CT-E9040

Locator drill

L1	L2	D
29	15	1.6

Material: Stainless steel

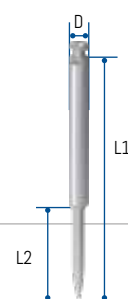

CT-2020

Initial drill

L1	L2	D
35.2	17.2	2.1

Material: Stainless steel

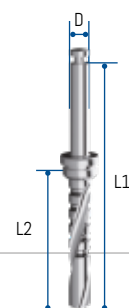

CT-1720E

Drill Extender

L
25

Note: This item is intended as a drill extender and will not support more than 40Ncm. It is not intended as implant driver extension.

Material: Stainless steel



CT-2000

Stops

L1	L	D	item#
13.1	6.4	5.2	CT-STOP06
12.1	7.4		CT-STOP02
11.1	8.4		CT-STOP01
10.1	9.4		CT-STOP07
9.1	10.4		CT-STOP03
8.1	11.4		CT-STOP08
7.1	12.4		CT-STOP12
6.1	13.4		CT-STOP09
5.1	14.4		CT-STOP14
4.1	15.4		CT-STOP10

Material: Titanium grade 5

Main drills

L	D	Fixture	item#
19.2	3.3		CT-1735E
	4		CT-1743E
	4.8		CT-1751E

Material: Stainless steel

Bone tap

L	D	Fixture	item#
18.66	3.45		CT-7154E
	4.1		CT-7155E
	4.9		CT-7151E

Material: Titanium grade 5

Counterbore

L	D
27.5	4.6

Material: Titanium grade 5

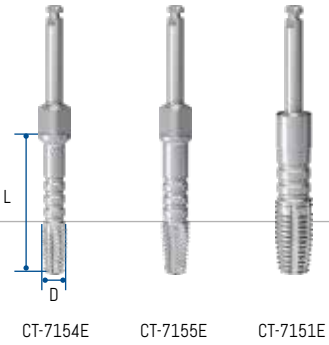
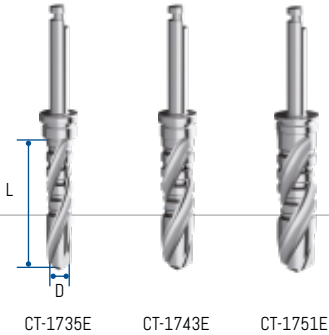
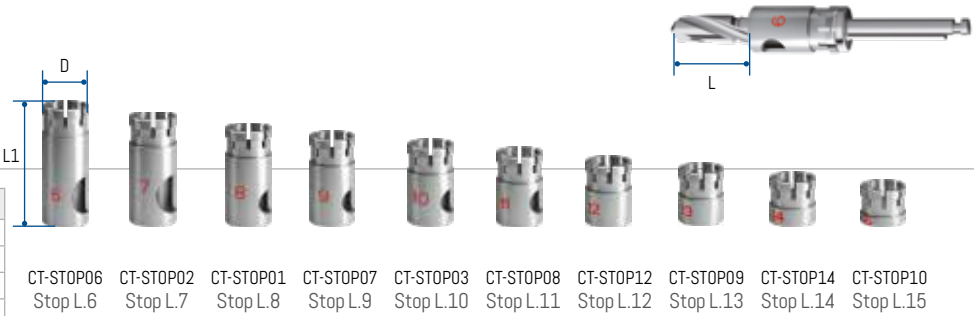

CT-2035E

Instrumentation

Hex drivers

L	item#
12.5	CT-9025S
18.5	CT-9025

Material: Stainless steel



Prosthetic latch driver

L
26.5

Material: Stainless steel



Torque wrench attachments

L	item#
12.5	CT-8051
18.5	CT-8052

Material: Stainless steel

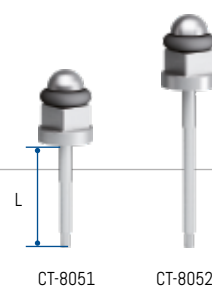

Prosthetic extractor

L
14.2

Material: Titanium grade 5



Latch driver prosthetic extractor

L
34.25

Material: Stainless steel



Finger adapter

L	D	item#
5.8	12.7	CT-E7002
8.61	8	CT-E7003

Material: Stainless steel

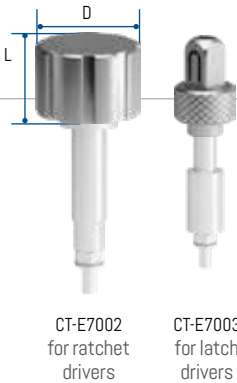

Torque Wrench 50Ncm

Material: Stainless steel



CT-8010

Torque Wrench PEEK

Material: Stainless steel and PEEK



CT-8010PEEK

Site preparation D2/D3

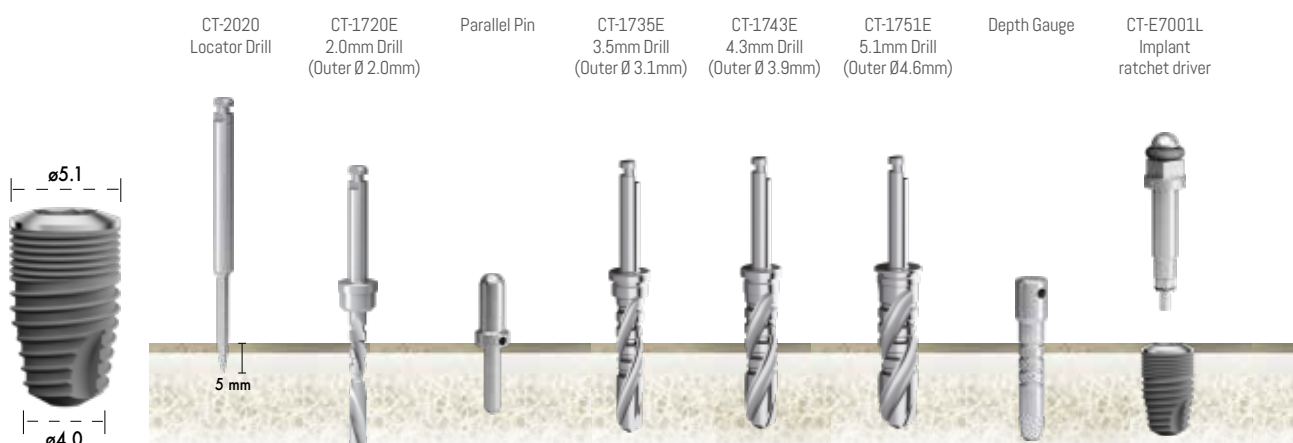
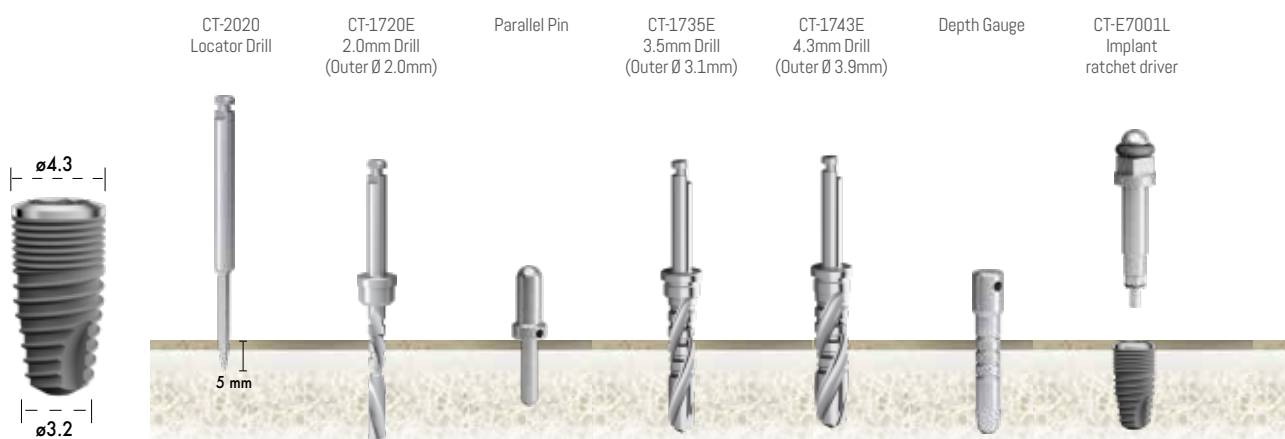
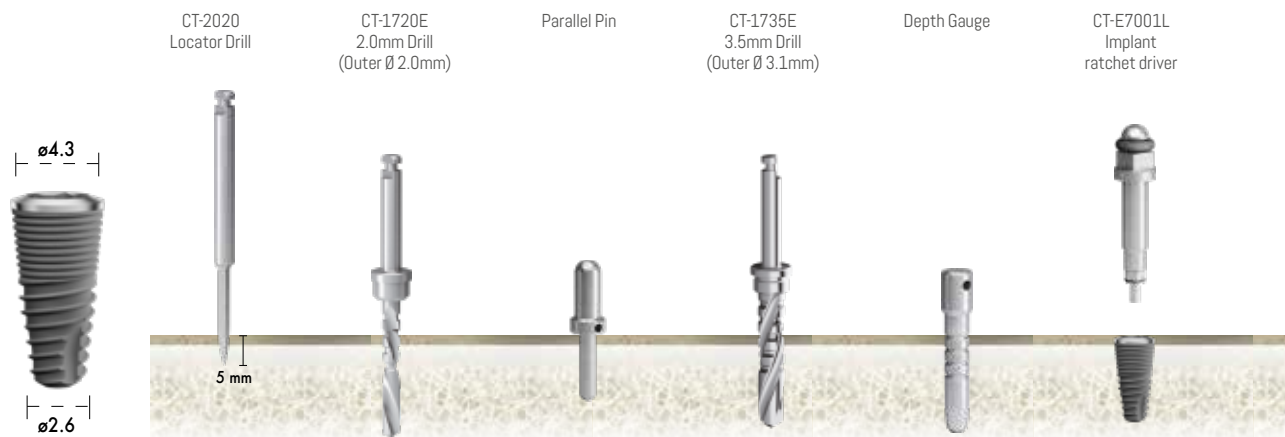

IMPORTANT: An additional 0.4 mm must be added to the length of the drill to account for the angled cutting tip.

D1 additional steps

CT-2035E
Irrigated
Counterbore

CT-7154E
3.5mm Bone Tap
(Outer Ø 3.4mm)

CT-E9040
Implant latch driver

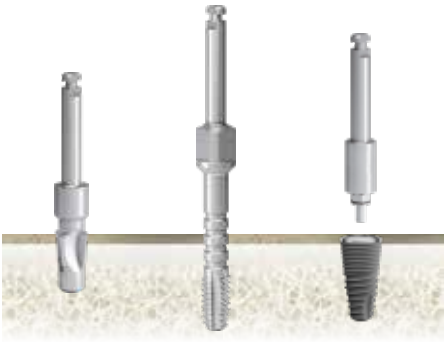

CT-2035E
Irrigated
Counterbore

CT-7155E
4.3mm Bone Tap
(Outer Ø 4.2mm)

CT-E9040
Implant latch driver



CT-7151E
5.1mm Bone Tap
(Outer Ø 5.0mm)

CT-E9040
Implant latch driver



Note: Metal stoppers can not be mounted on Ø 5.1 drills

Explanation of Drill Marking

- The drill markings do not include the point of the drill.
- The point of the drill is 0.4 mm long, thus the drill marking of 7 mm is actually 7.4 mm from the very tip to the bottom of the first black line

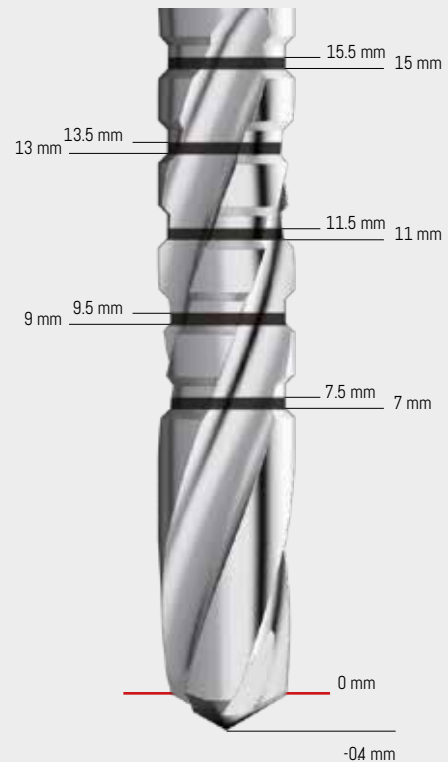

Counterbore

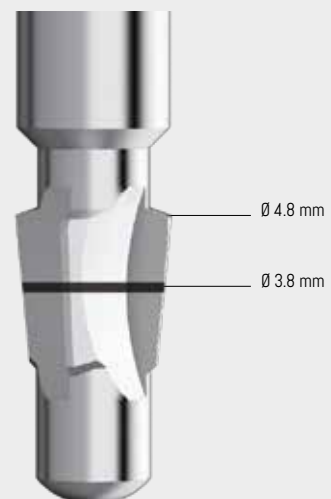

Implant packaging

The implant packaging is endowed with 3 levels of security; a double vial inside an airtight blister pack. Within the vials the implant is maintained upright by a titanium ring and supported at the implant apex by the titanium cover screw.



Implant labeling

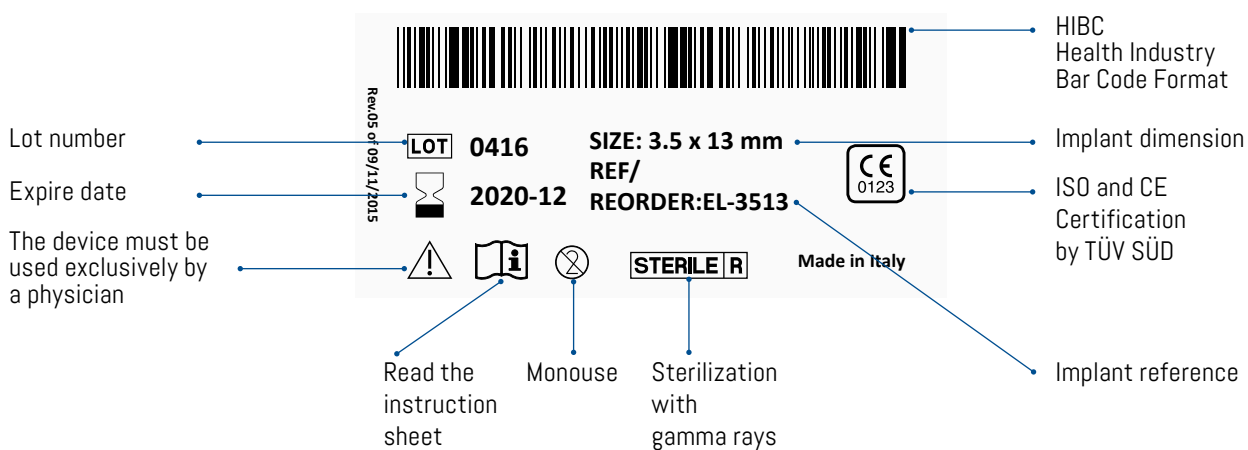

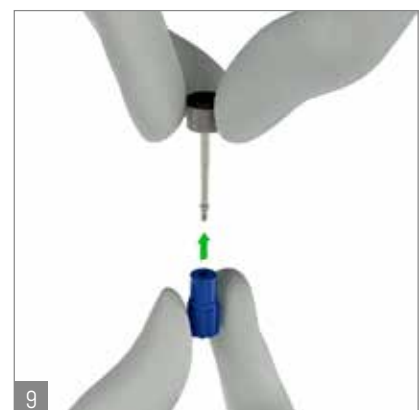
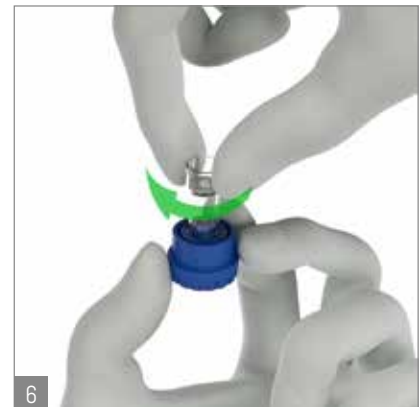

English version



REV. 02 / 11-2018

C-TECH
CENTURY IMPLANT TECHNOLOGIES

Via Cesare Battisti n. 2 - 40123, Bologna - ITALY - Tel. +39 051 6661817 - Fax +39 051 6667071
www.c-tech-implant.com - info@c-tech-implant.com

Go to
www.c-tech-implant.com



Follow us on facebook
[f/CTechimplant](https://www.facebook.com/CTechimplant)

